

- Grading Notes:**
- 1) Approval of this plan is not an authorization to grade adjacent properties. When field conditions warrant off-site grading, permission must be obtained from the affected owners.
 - 2) All contours and spot elevations reflect finished grades.
 - 3) All elevations are in reference to the benchmark.
 - 4) Contractor shall verify the benchmark prior to ground breaking.
 - 5) The contractor shall immediately report to owner any discrepancies found between actual field conditions and construction documents and shall wait for instructions prior to proceeding.
 - 6) Contractor shall verify location of all existing utilities in the field prior to beginning construction.
 - 7) Contractor shall blend new earthwork smoothly to transition back to existing grade.
 - 8) See Geotechnical report for compaction requirements.
 - 9) Contractor shall ensure positive drainage such that runoff will drain by gravity flow across any disturbed area.

See sheet C-7.1 for Grading and Erosion Control Notes

Grading Plan Legend:

- Existing Storm Drainage
- Proposed Storm Drainage
- Denuded Limit
- - - 650 Existing Contours
- - - 650 Proposed Contours
- Silt Fence
- Hardware Cloth & Gravel Inlet Protection
- x 560.0 Existing Spot Elevation
- x 560.0 Proposed Spot Elevation

Site Notes:

- 1) Applicant: Dena Sabinske
Town of Waxhaw Annex
317 N. Broome St, PO Box 6
Waxhaw, NC 28173
Phone: 704-843-2195 x278
dsabinske@waxhaw.com
- 2) Site Acreage: +/- 24.84 Acres
- 3) Parcel Number: 06-192-001
- 4) Current Zoning: TbC2 & ScA
- 5) Soils: 0.30 Acres
- 6) Disturbed Area: 0.30 Acres
- 7) Drainage Basin: Site drains to Twelve Mile Creek

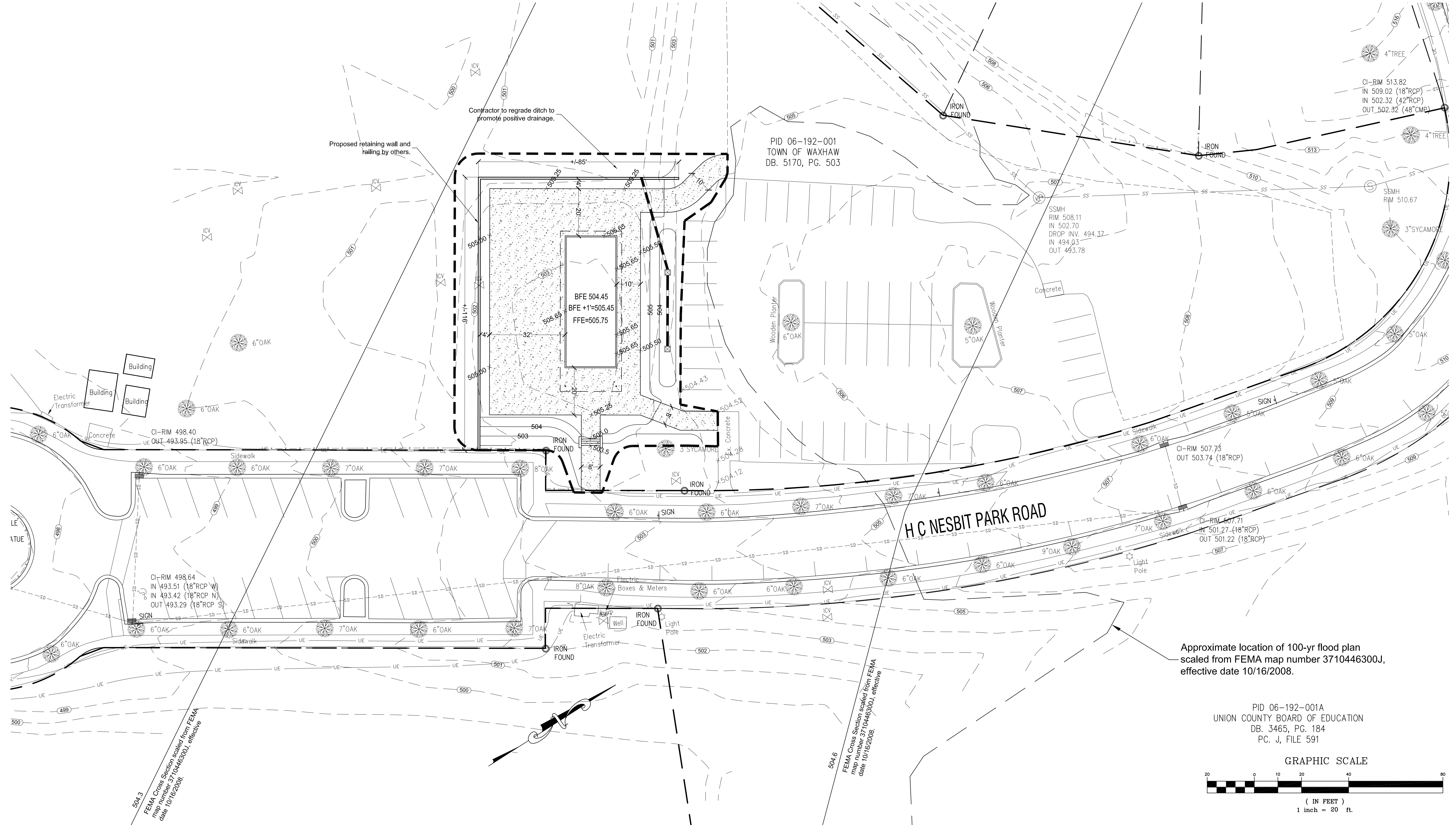

504.3
FEMA Cross Section scaled from FEMA map number 3710446300J, effective date 10/16/2008.

504.6
FEMA Cross Section scaled from FEMA map number 3710446300J, effective date 10/16/2008.

Approximate location of 100-yr flood plan scaled from FEMA map number 3710446300J, effective date 10/16/2008.

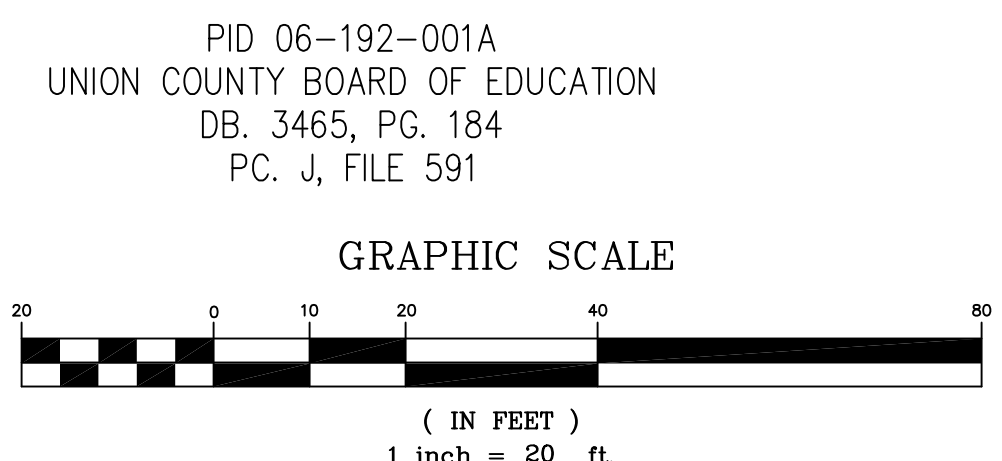

LAWRENCE - SEVIER Lawrence Projects 14727 Town of Waxhaw - Nesbit Park 14727 - Civil Base 04.02.18.dwg 4/13/2018 2:29:13 PM EDT

NO.	DATE	BY	ISSUE

**Town of Waxhaw
Nesbit Park**

Attn.: Dena Sabinske
Town of Waxhaw Annex
317 N. Broome St., PO Box 6
Waxhaw, NC 28173
Phone: 704-843-2195 x278
dsabinske@waxhaw.com

LAWRENCE ASSOCIATES

105 W. Jefferson St.
Monroe, North Carolina 28112
P 704-289-1013 F 704-283-9035
www.lawrenceurveying.com
Firm License Number: C-3956

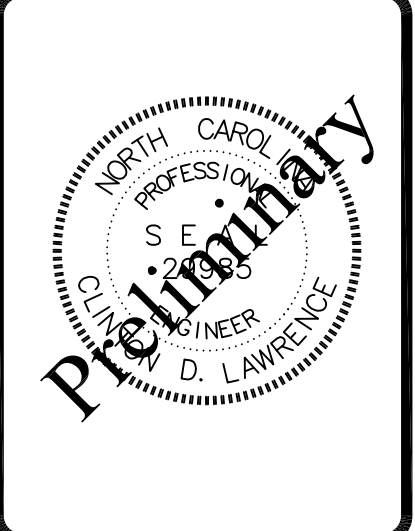

DESIGNED BY	CIL	CHECKED BY	FDL
DRAWN BY	CIL	DATE	02/09/18
SCALE	1" = 20'	SHEET NUMBER	4723

C-3.0