

PROJECT SUMMARY

PROJECT NAME: WAXHAW COMMONS MEDICAL PLAZA
 OWNER/DEVELOPER: WATH INVESTMENTS
 PLANS PREPARED BY: SEEDWATER ENGINEERING
 TAX PARCEL NUMBER: 081419025, 081419026 & 081419027
 EXISTING ZONING: NC
 JURISDICTION: TOWN OF WAXHAW
 TOTAL SITE AREA: 4.43 ACRES

SITE DEVELOPMENT DATA-

SETBACKS:
 FRONT 20'
 SIDE 5'
 REAR 30'

PROPOSED BUILDING SQUARE FOOTAGE
 21,600 SF BUILDING
 14,940 SF BUILDING
 3,800 SF BUILDING
 46,340 SF TOTAL

REQUIRED PARKING

4 SPACES / 1000 SF OF BUILDING AREA
 46,340 SF BUILDING
 46,340 SF / 1000 SF = 46.34 = 185 SPACES REQUIRED
 SPACES PROVIDED = 180 SPACES PROVIDED

PARKING REQUIRED

185 SPACES

TOTAL IMPERVIOUS AREA: 1,18,879.64 SQ FT
 2.71 CRORES

TOTAL SITE AREA: 1,92,799.12
 4.42 ACRES

TOTAL IMPERVIOUS % SITE: 61.73%

PUBLIC OPEN AREA REQUIRED 2.0%
 TOTAL SITE AREA: 4.42 ACRES OR 192,739 SF
 OPEN AREA REQUIRED: 3,855 SF

NO. 1
 TAX # 08-141-021
 RUBY VT, LLC ETAL
 58.875 AC. PC 200
 ZONING: NEIGHBORHOOD

ALMA BOULEVARD
 VARIABLE WIDTH R/W (PC FILE 298)

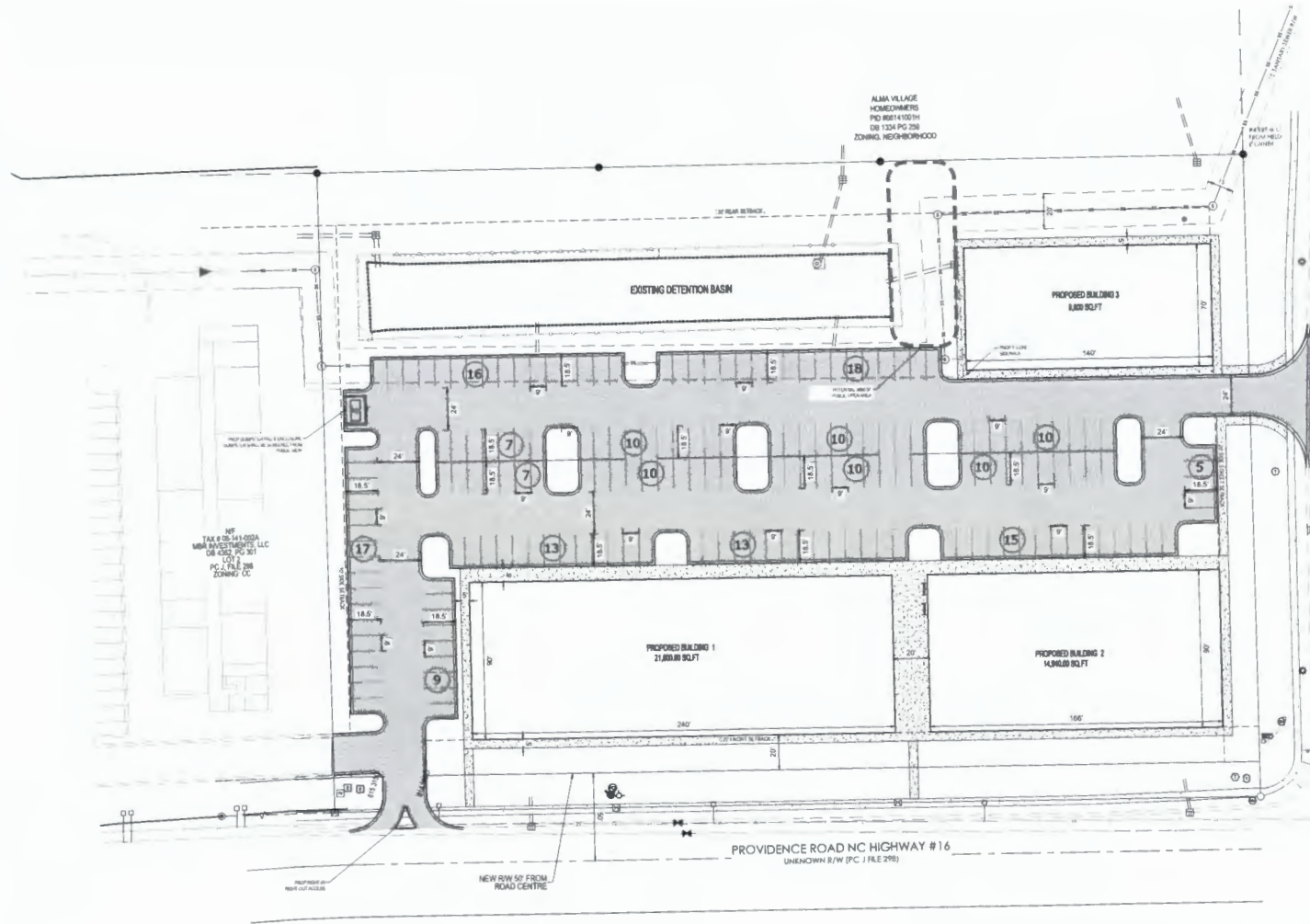

DATE	DESCRIPTION

PROJECT NO.	
DATE	

WAXHAW COMMONS
COMMERCIAL PLAZA

SHEET INDEX

- C1.0 SITE PLAN
- C2.0 LANDSCAPE PLAN
- C3.0 PRELIMINARY GRADING PLAN
TOPOGRAPHIC SURVEY



SITE PLAN
C1.0